

Technical Catalog





Excellence in PVC Extrusions



Our Story

Our parent company, Lucky Industries, began aluminum extrusions over 25 years ago, in Karachi, Pakistan. Now, Lucky Aluminium is the most well-known name in aluminum sector. We are one of the largest aluminum profile extruders with a sales network spread throughout Pakistan.

In 1999, we established a plastics division in Hub, Balochistan. Here we produce LLDPE high shrink film for the packaging industry.

In 2005, New Era Industries was established. At that time, we were the only company making uPVC window profiles in Pakistan. Here we extrude uPVC window & door profiles in an advanced high tech extrusion plant with German technology. Our facilities include a modern laboratory, PVC compounding, extrusion lines and profile finishing.

Our Values

- The single reason for our existence is the pursuit of satisfaction for all our stakeholders. We believe we can build our brand and reputation if we provide our customers better value for their money, and our employees an opportunity to grow beyond themselves.
- Honesty, sincerity and expertise are values that can not be compromised.
- We like to dream. Dreams are always welcome. Because if you really work at them with all that you have, dreams do come true!
- We treat our customers, suppliers, employees, and other stake holders as partners. We believe, all of us can achieve our highest potential working together: not alone

Extrusion Technology

Best quality raw materials & equipment + capable human resource = best quality product. We follow this simple philosophy to produce the best quality profiles in Pakistan. We use high quality additives that impart the following properties to our profiles:

- **Impact strength**
- **High UV stability for hot climates**
- **Heat stability**
- **Gloss & Smoothness**



Our material suppliers include KRONOS, Baerlocher, Kaneka, BASF and other firms of repute.

Solutions Approach

We provide our customers all the products and services that facilitate the use of our product. We provide a complete solution.

We provide the following to our profile customers:

- UPVC Profiles
- All types of accessories
- Fabrication Machinery
- Marketing Support
- Technical Support

System Design

Our window systems are designed according to the needs of the local market. We work with hardware suppliers and system designers to come up with unique solutions for our customers. The main features of our window systems include:

- UPVC FLYSCREEN option for sliding and openable window systems
- Security Metal Grill option for sliding and openable systems
- Special water drainage slope
- Special border profiles for beauty
- Co-extruded gaskets



Quality Control

Our fully functional laboratory is unmatched in the private plastics processing sector in Pakistan. Random samples are taken from the production line and tests carried out on them. We have in-house facility to check tensile strength, corner weld strength, vicat softening point, & charpy impact strength.

OPAL

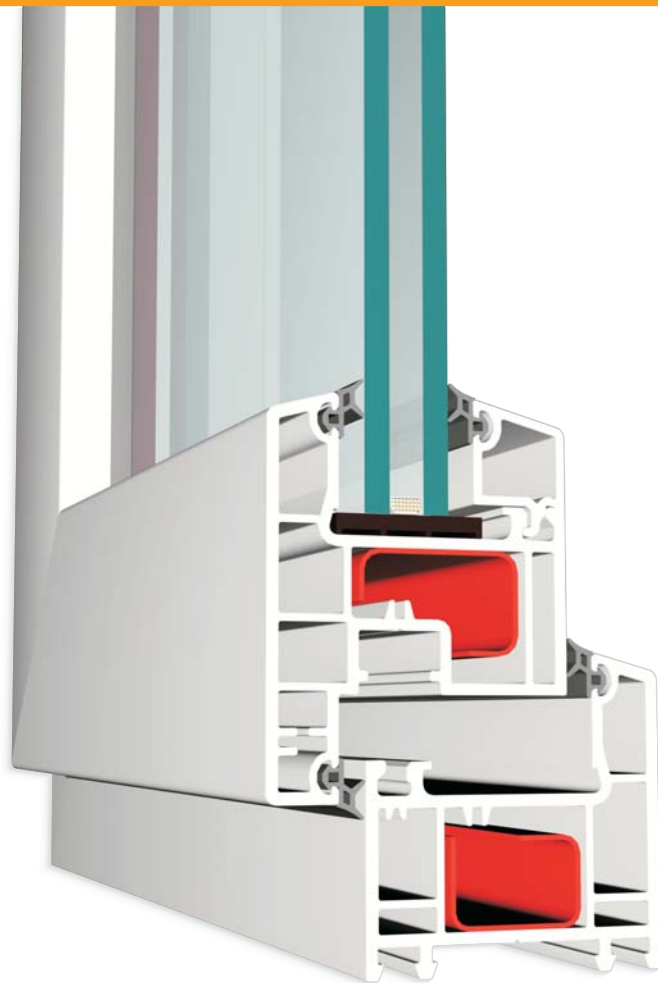

- Classic sharp edge design
- Economical design with 2.4mm and 2.5mm wall thickness
- Labor saving due to TPV and co-ex pre-inserted gaskets
- High heat & sound insulation by weldable TPV gaskets
- Special Hinges allow screws into the steel reinforcement for more strength
- 5mm, 12mm, 20mm, 24mm, 32mm glass possible
- Heat insulation upto 1.432 W/m²
- Sound Insulation upto 60 Db

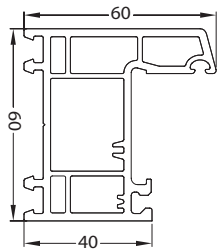

601.1 Frame

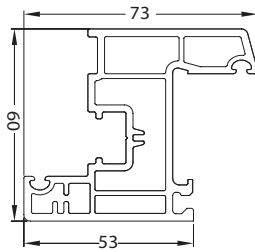

602.1 Inward Window Sash

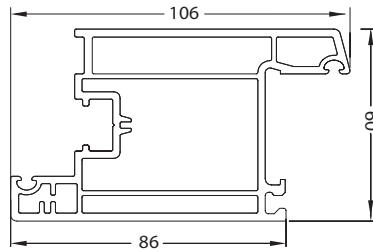

602.2 Inward Door Sash

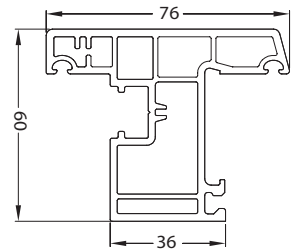

603.1 Outward Window Sash

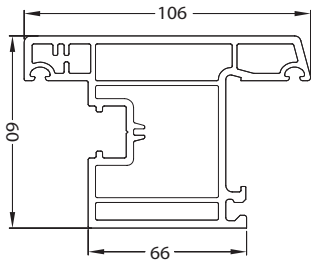

603.2 Outward Door Sash

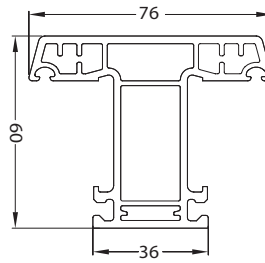

604.1 Mullion

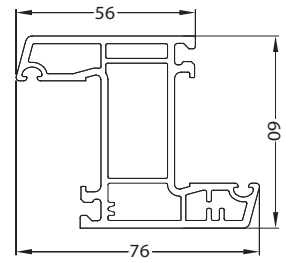

604.2 Z-Mullion

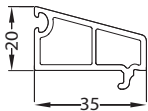

605.1 Beading

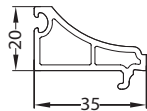

605.11 Beading

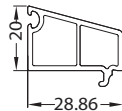

605.3 Beading

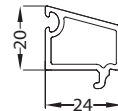

605.4 Beading

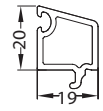

605.5 Beading

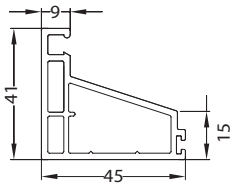

606.1 Openable Screen Sash

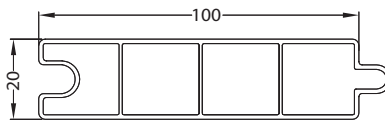

609.1 Door Panelling

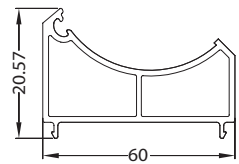

609.2 Bay Post Adaptor

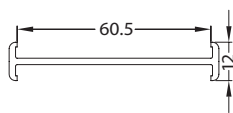

609.3 60 Frame Connector

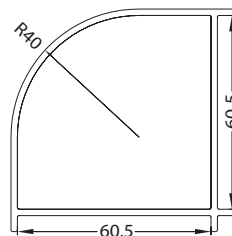

609.4 60-60 Curved Corner

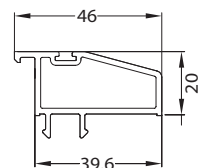

609.5 Door Closing Frame

Royal

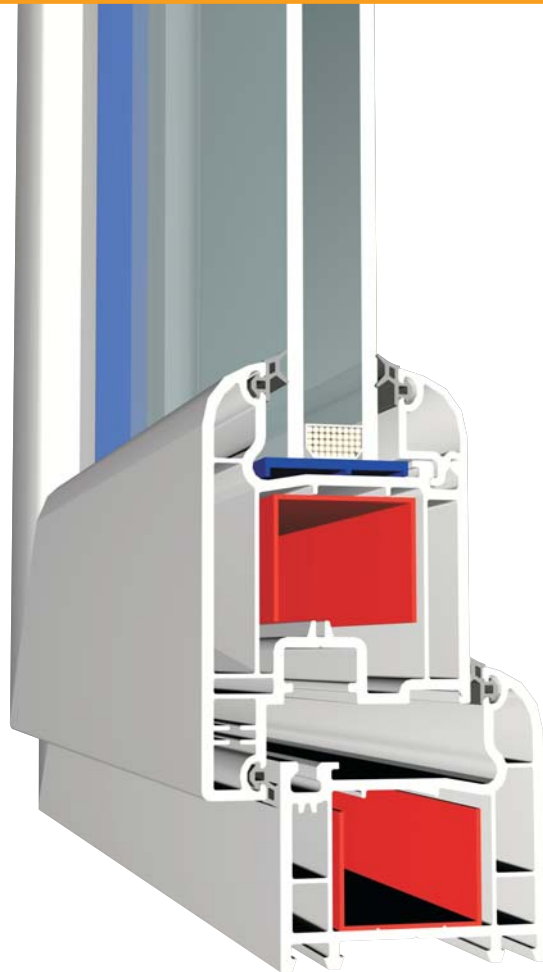

- Beautiful appearance due to rounded edges
- Strong design with 2.6mm wall thickness & 3 chamber design.
- Labor saving due to TPV and co-ex pre-inserted gaskets
- High heat & sound insulation by weldable TPV gaskets
- Special water drainage slope
- Special hinges allow screws into the steel reinforcement for more strength
- 5mm, 12mm, 20mm, 24mm, 32mm glass possible
- Heat insulation upto 1.432 W/m²
- Sound Insulation upto 60 Db

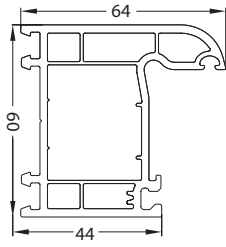

601.2 Frame

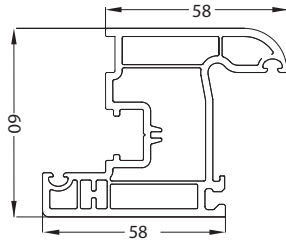

602.3 Inward Window Sash

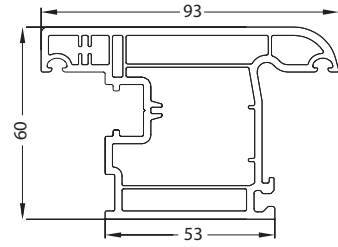

603.3 Outward Window Sash

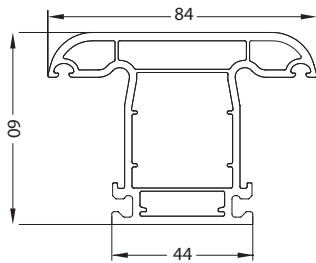

604.3 Mullion

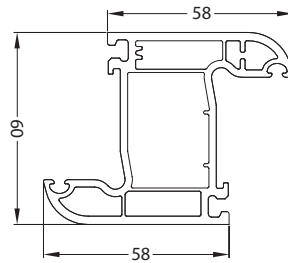

604.4 Z Mullion

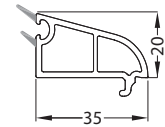

605.12 Beading

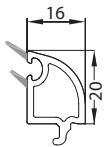

605.6 Beading

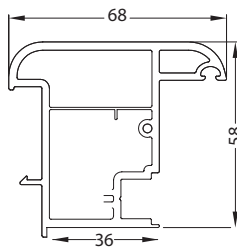

609.7 Double Sash Coupler

CRYSTAL

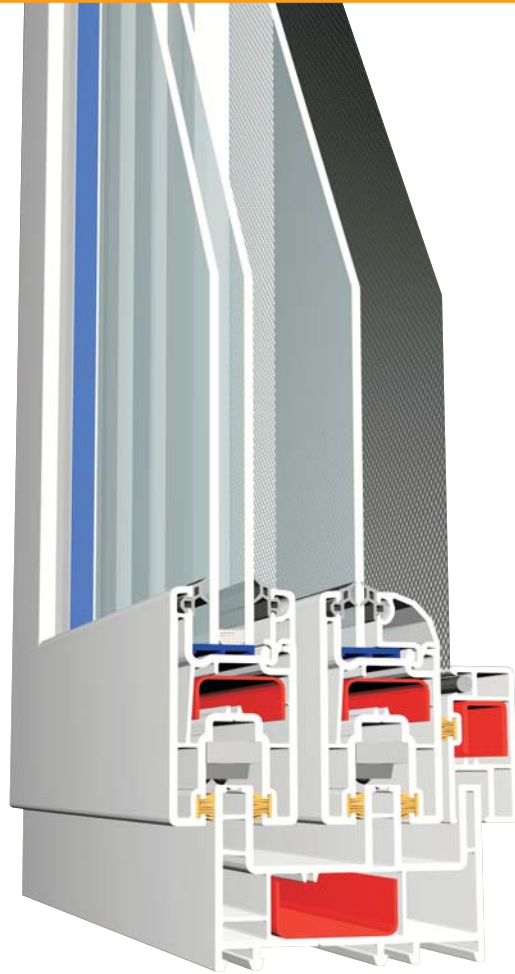

- Economical 80mm, 3 track sliding system with 2.2mm wall thickness
- Exclusive PVC flyscreen track and sash
- Special detachable rail track
- Labor saving due to TPV and co-ex pre-inserted gaskets
- High heat & sound insulation by weldable TPV gaskets
- Brush seal groove on all sashes
- 5mm, 8mm, 12mm and 18mm glass possible

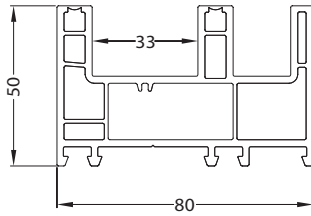

801.1 Frame

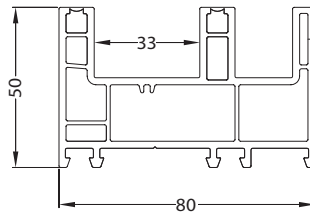

801.1B Frame

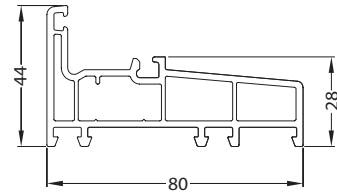

801.2 Sliding Fixed Frame

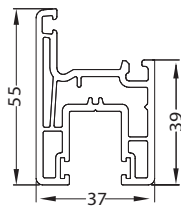

802.1 Window Sash

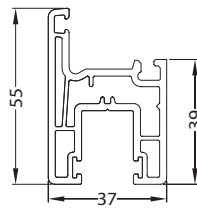

802.1B Window Sash

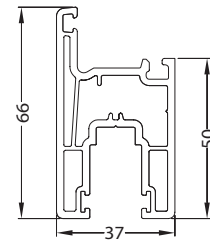

802.2 Large Sash

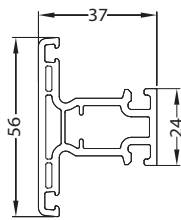

804.1 Sash Mullion

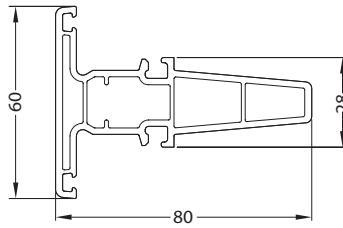

804.2 Frame Mullion

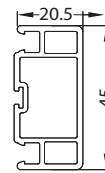

804.3 Screen Sash Mullion

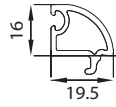

805.1 Beading

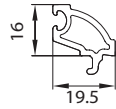

805.11 Beading

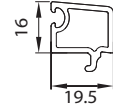

805.12 Beading

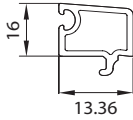

805.3 Beading

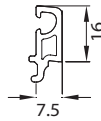

805.4 Beading

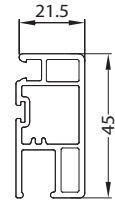

806.1 Screen Sash

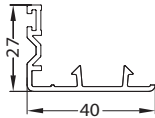

809.1 Interlock

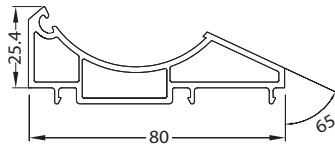

809.2 80-Bay Post Adapter

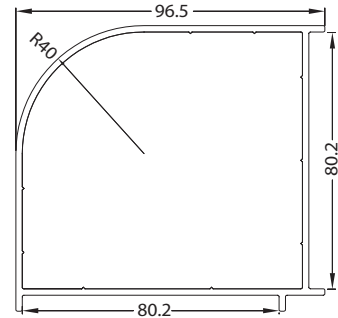

809.4 80-Curved Corner

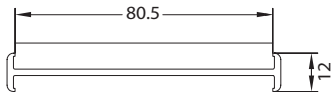

809.3 Frame Connector

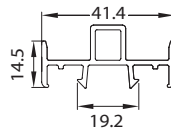

809.5 Inline Adapter

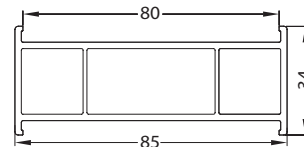

809.6 80-Frame Connector

Auxiliary

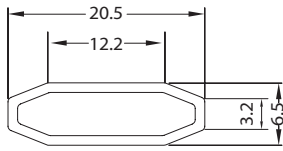

109.1 Georgian Bar

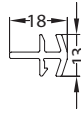

109.2 Frame Connector

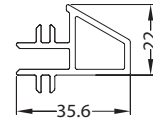

109.3 Frame Connector

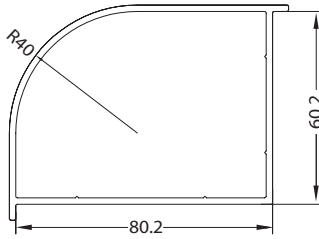

109.4 80-60 Curved Corner



109.5 Frame

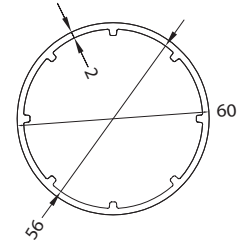

109.6 Bay Post

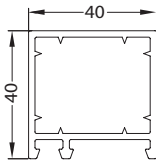

109.7 Frame Extension

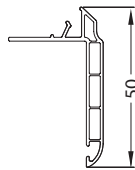

109.8 Border

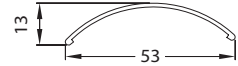

B-7 Top Border Profile

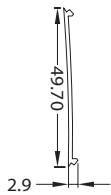

B-8 Bottom Border Profile

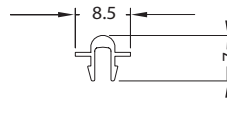

Alu. Rail

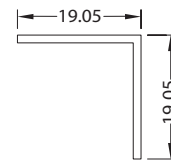

3/4 x 3/4 Alu. Angle

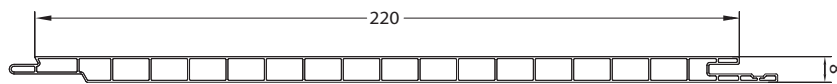

220 x 8 Wall Panel

Assembly Drawings

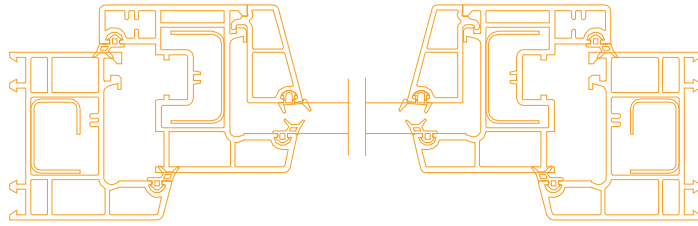

O P A L

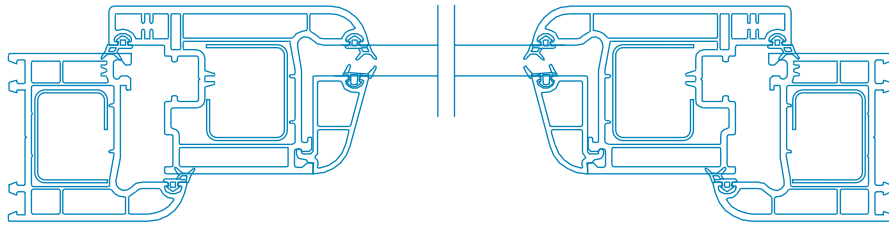

R O Y A L

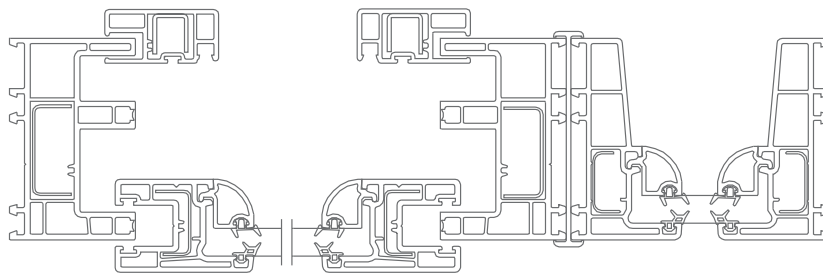

C R Y S T A L

Reinforcement

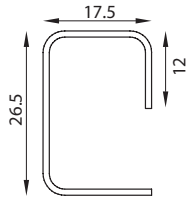

601.1 Frame

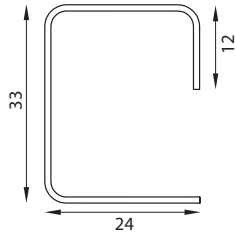

601.2 Frame

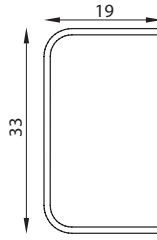

602.1 Inward window sash

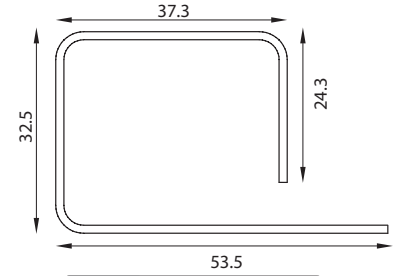

603.2 Outward door sash
602.2 Inward door sash

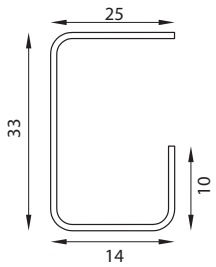

602.3 Inward sash

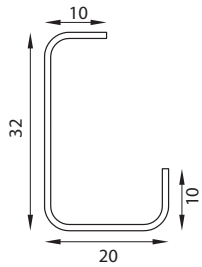

603.1 Outward window sash

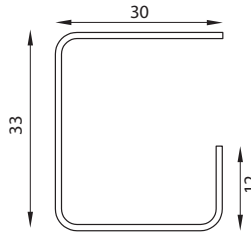

603.3 Outward Door sash

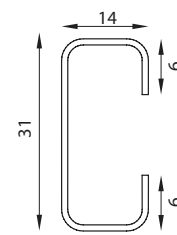

604.1 Mullion

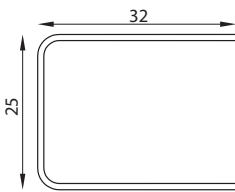

604.3 Mullion

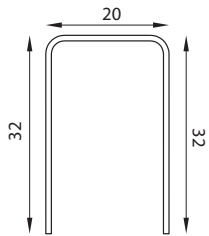

604.4 Z Mullion

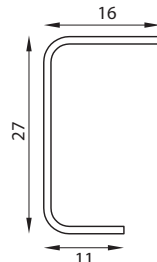

606.1 Screen sash

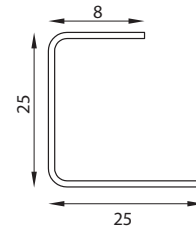

609.7 Double sash coupler

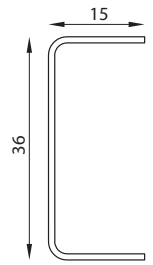

801.1 Frame

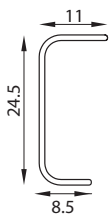

801.2 Fix Frame

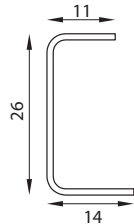

802.1 Window sash

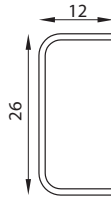

802.2 Large Sash

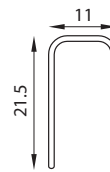

804.2 Frame Mullion

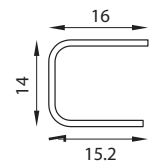

806.1 Screen Sash

HARDWARE



11300



L-11480 / R-11490

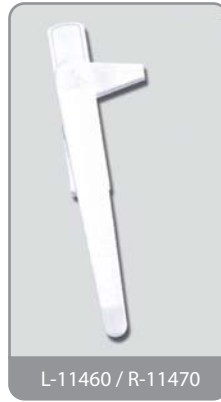

L-11460 / R-11470



FL-013

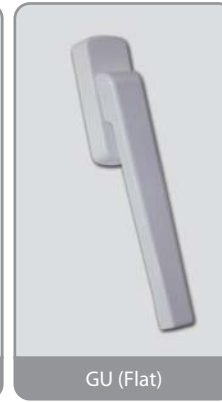

GU (Flat)

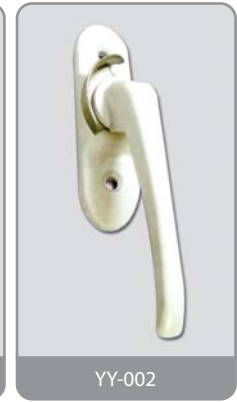

YY-002



12600



12600-2



12600-3

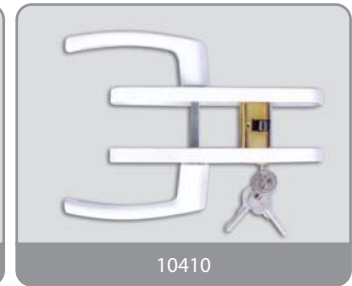

10410



IZMIR



Hoppe



ST-121

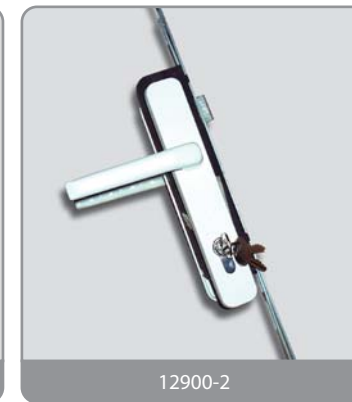

12900-2



12900



10560



6230



6110



6040



Window Gear (Sliding, Inward, Outward)

Hardware

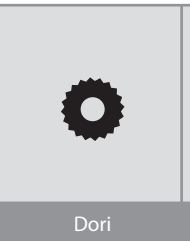
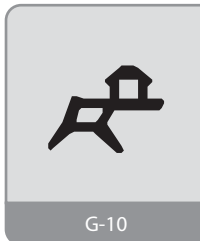
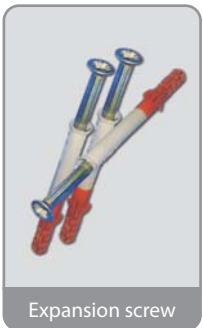
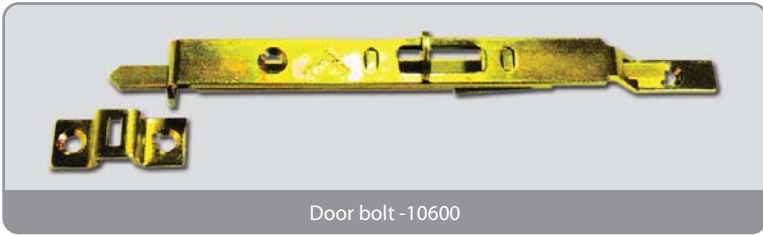

Tilt & Turn

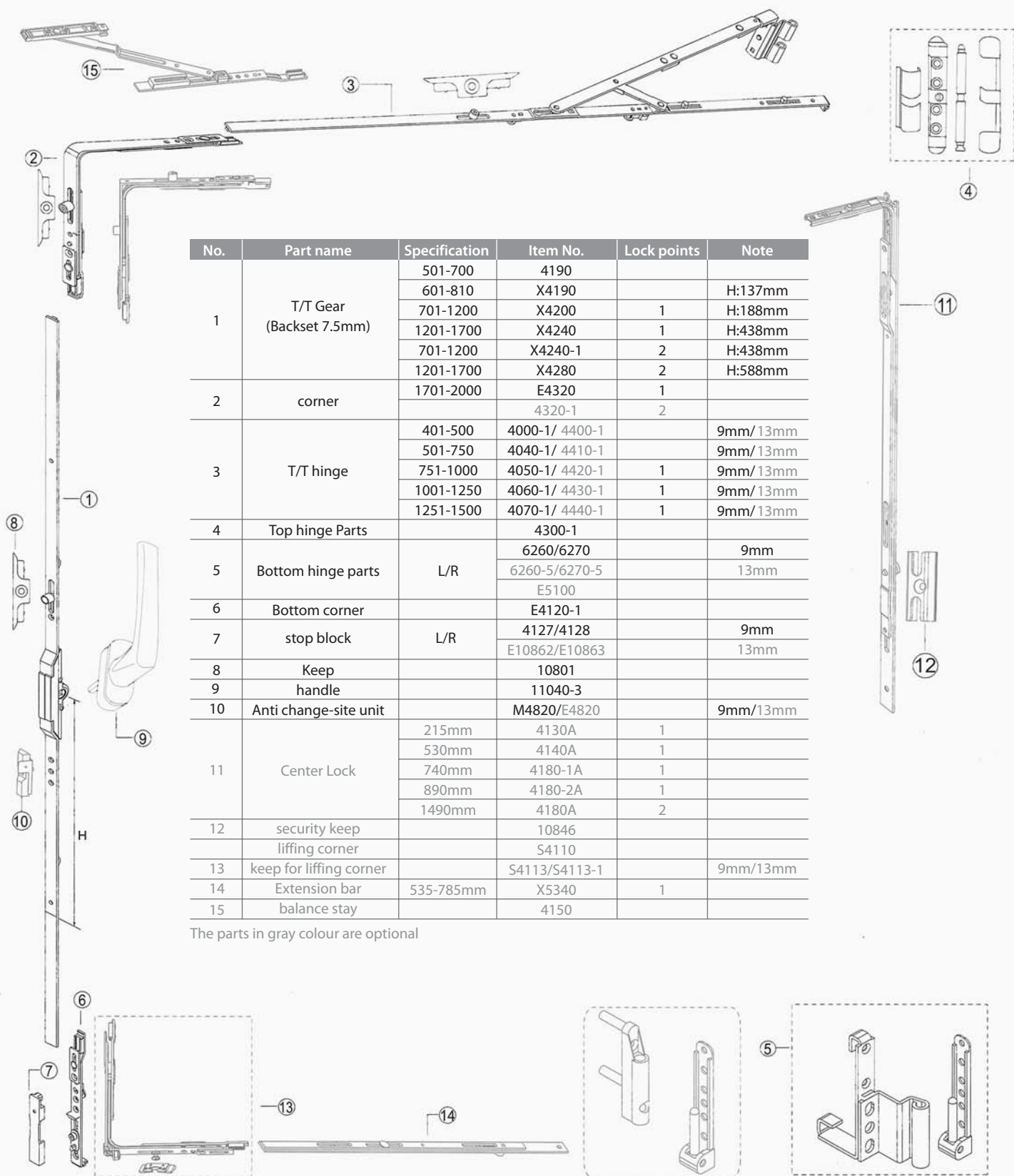

No.	Part name	Specification	Item No.	Lock points	Note	
1	T/T Gear (Backset 7.5mm)	501-700	4190			
		601-810	X4190		H:137mm	
		701-1200	X4200	1	H:188mm	
		1201-1700	X4240	1	H:438mm	
		701-1200	X4240-1	2	H:438mm	
2	corner	1201-1700	X4280	2	H:588mm	
		1701-2000	E4320	1		
3	T/T hinge		4320-1	2		
		401-500	4000-1/ 4400-1		9mm/ 13mm	
		501-750	4040-1/ 4410-1		9mm/ 13mm	
		751-1000	4050-1/ 4420-1	1	9mm/ 13mm	
		1001-1250	4060-1/ 4430-1	1	9mm/ 13mm	
4	Top hinge Parts	1251-1500	4070-1/ 4440-1	1	9mm/ 13mm	
			4300-1			
5	Bottom hinge parts	L/R	6260/6270		9mm	
			6260-5/6270-5		13mm	
6	Bottom corner		E5100			
7	stop block	L/R	E4120-1			
8	Keep		4127/4128		9mm	
			E10862/E10863		13mm	
9	handle		10801			
10	Anti change-site unit		11040-3			
11	Center Lock		M4820/E4820		9mm/13mm	
		215mm	4130A	1		
		530mm	4140A	1		
		740mm	4180-1A	1		
		890mm	4180-2A	1		
12	security keep liffing corner		1490mm	4180A	2	
				10846		
			S4110			
13	keep for liffing corner		S4113/S4113-1		9mm/13mm	
14	Extension bar	535-785mm	X5340	1		
15	balance stay		4150			

The parts in gray colour are optional

Wood Max System

Wooden Textured UPVC Window & Door Profiles



Natural Oak

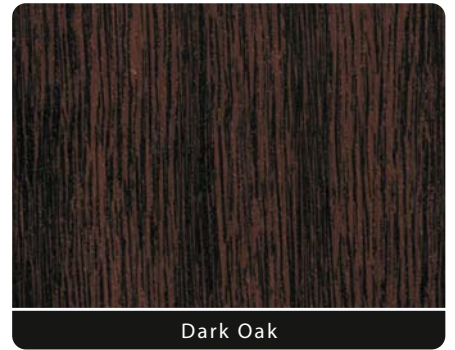

Dark Oak

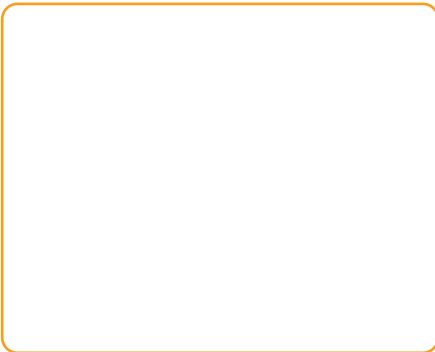

Golden Oak

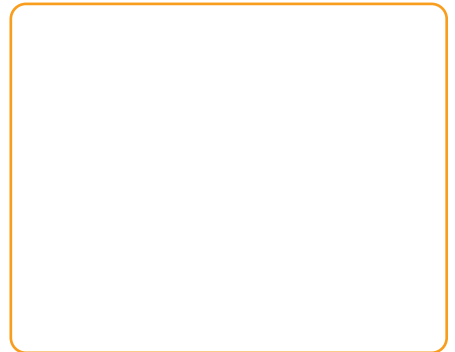

Nussbaum

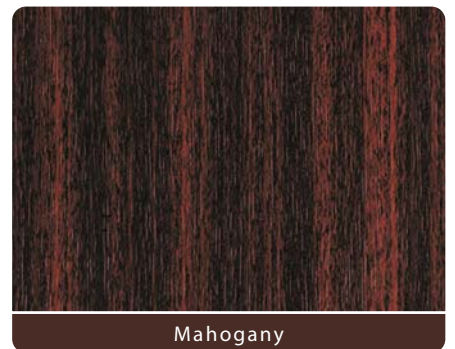

Mahogany



New Era Industries (SMC Pvt) Ltd.

F-61/G, S.I.T.E., Karachi-75730
Pakistan.

Tel: +(9221) 32589004-6

Fax: +(9221) 35206488/32589007

sales@nei.net.pk